



"The mermaid and the fisherman"  
by Lord Frederick Leighton

"EMOTIONAL FOG" IS A LIGHT INSTALLATION FOR PUBLIC SPACE THAT REACTS TO RELATIVE HUMIDITY CONDITIONS FORMING NEW RELATIONAL SPACES BASED ON THE PSYCHOLOGY OF COLOR.

CONTEXT: THE LEGEND

The EMOTIONAL FOG makes the legend emotional reality. A magical public space that generates emotions both of the beholder as to who gets into it. A subtle landscape during the day, almost transparent. Overnight completely transforms the image of the city.

Remember the legend in the context of Copenhagen: Legend has it that the songs of the Sirens bewitch men of the sea and the city of Copenhagen. A fisherman while working was fascinated by the voice of a young mermaid. The Little Mermaid gave up her immortality in exchange for the appearance of a woman to get to keep the love of her prince.



"Emotional Fog". Mermaid view

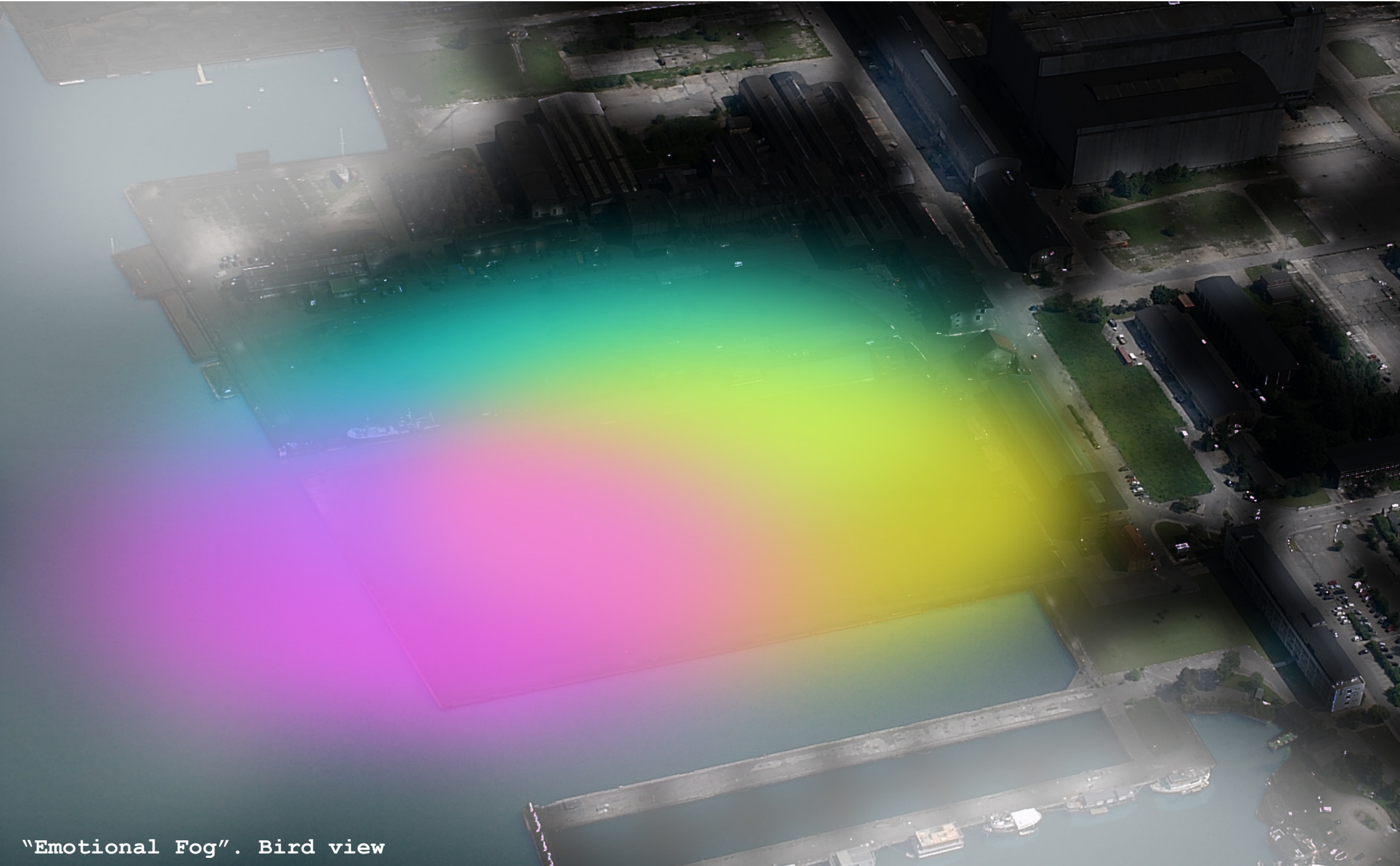

"Emotional Fog". Bird view

CONTEXT: THE CLIMATE

The relative humidity in Copenhagen throughout the year is very high. This circumstance causes the appearance of different types of fog. This fogs are used as a mechanism to create the emotional relationship spaces.

COPENHAGEN: AVERAGE MONTHLY HOUR FOG

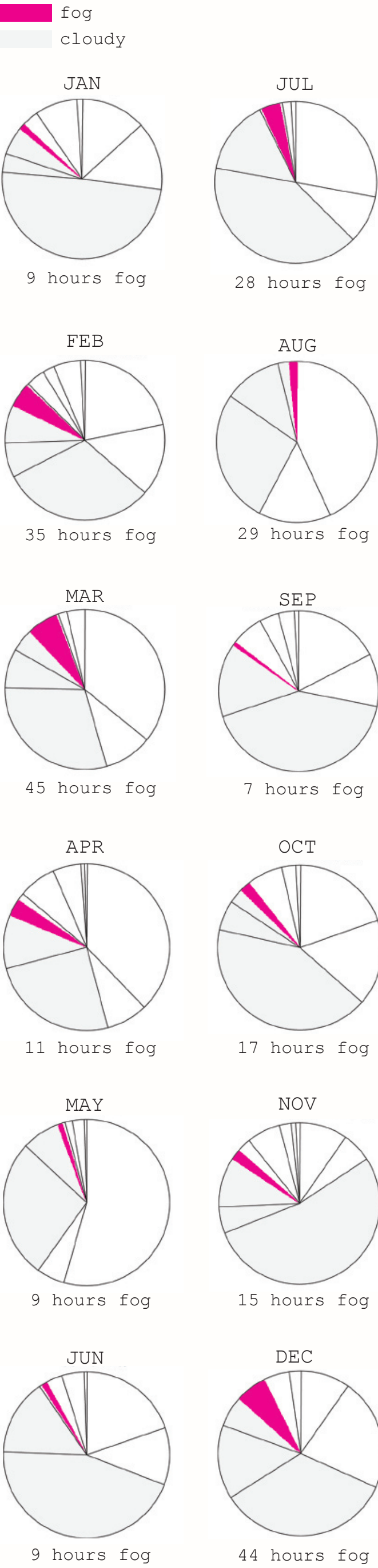

COPENHAGEN: RELATIVE HUMIDITY/MONTH

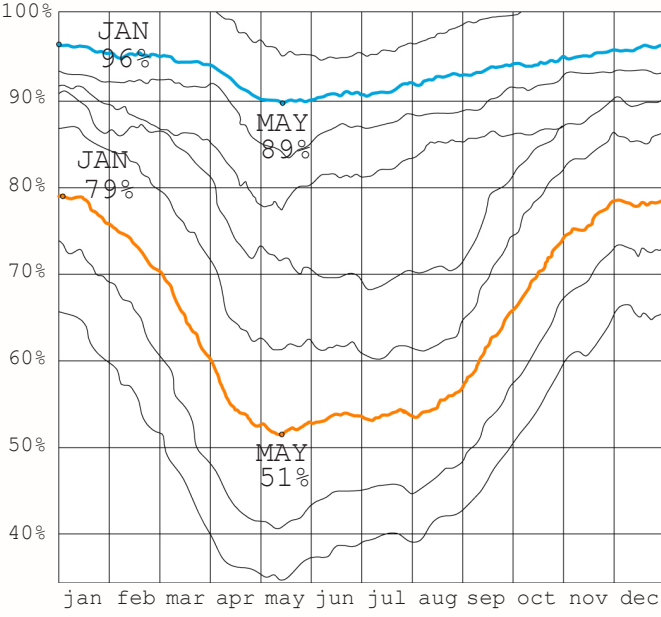

COPENHAGEN: TYPES OF FOG

Fog occurs on certain days a year and not continuously. This makes this wonderful show is unique and special.

RADIATION FOG

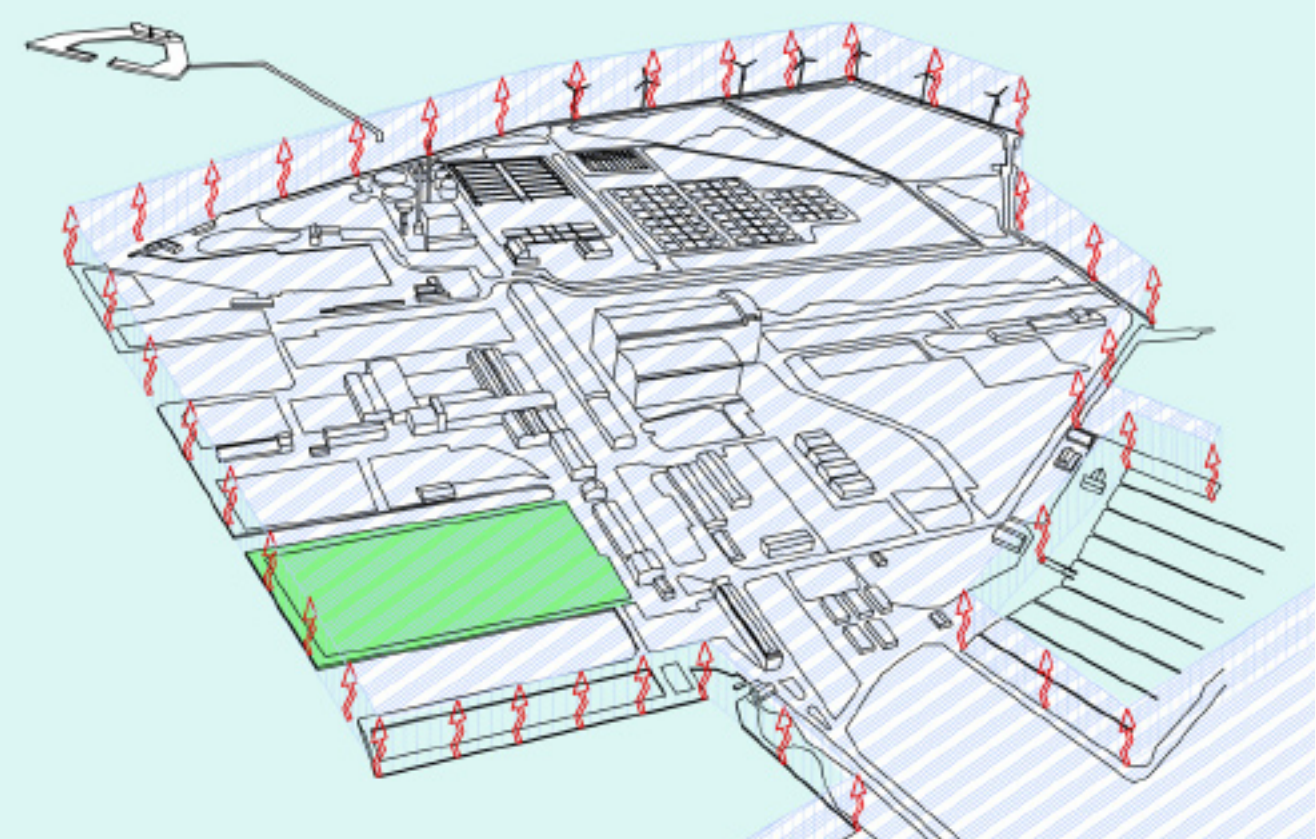

Radiation fog usually occurs in the winter, aided by clear skies and calm conditions. The cooling of land overnight by thermal radiation cools the air close to the surface. This reduces the ability of the air to hold moisture, allowing condensation and fog to occur. Radiation fogs usually dissipate soon after sunrise as the ground warms.

ADVENTION FOG

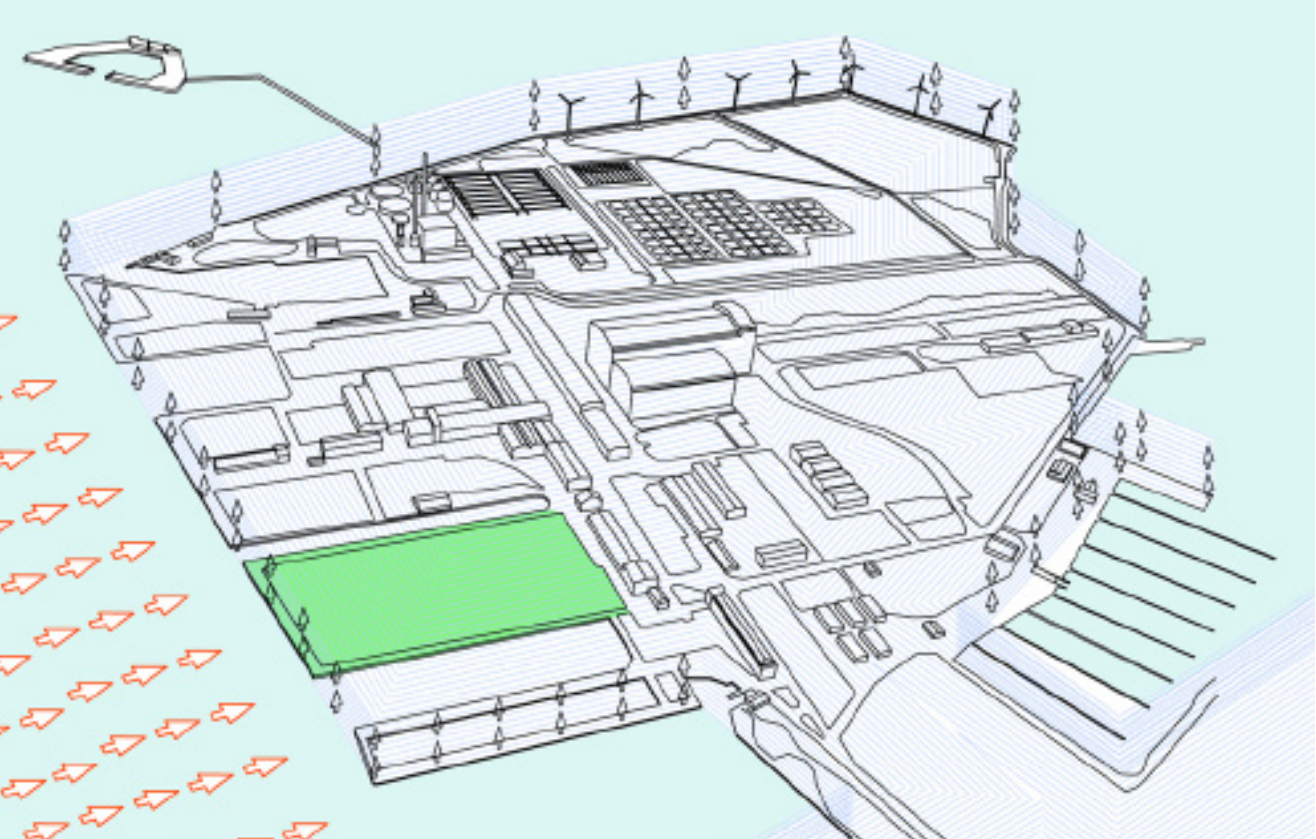

Advection fog occurs when moist air passes over a cool surface and is cooled. A common example of this is when a warm front passes over an area with snow cover.

EVAPORATION FOG

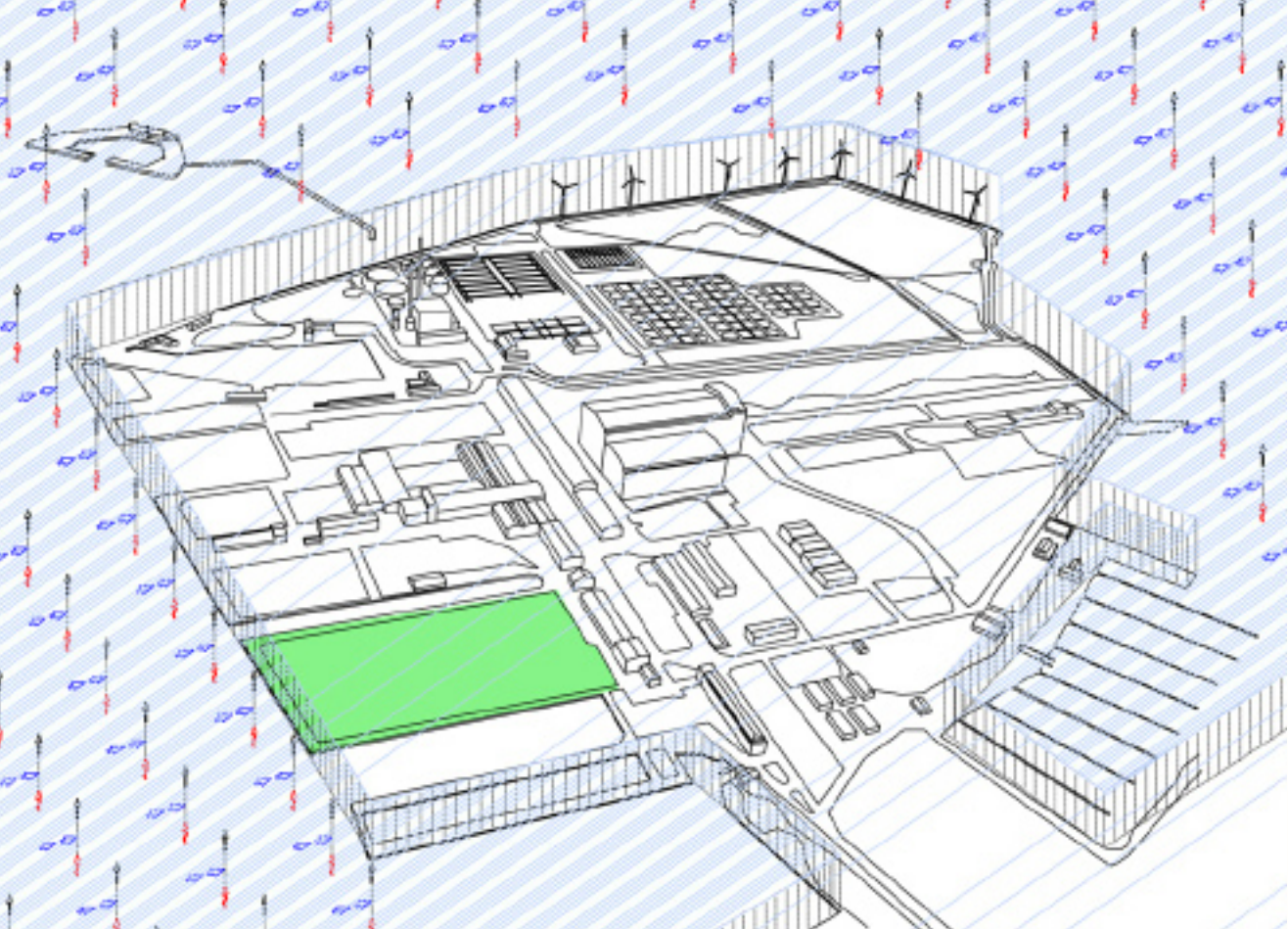

Evaporation fog is caused by cold air passing over warmer water or moist land. It often causes freezing fog, or sometimes Types of frost. When some of the relatively warm water evaporates into low air layers, it warms the air causing it to rise and mix with the cooler air that has passed over the surface. The warm, moist air cools as it mixes with the colder air, allowing condensation and fog to occur.

REAL SIMULATION OF FOG

Small facility to simulate the effect of a fog using a cannon smoke. Conclusions:

- The long wavelength reflects more light than the wave short in the same type of colloidal system.
- Very different sensations depending on the color in which we are immersed.

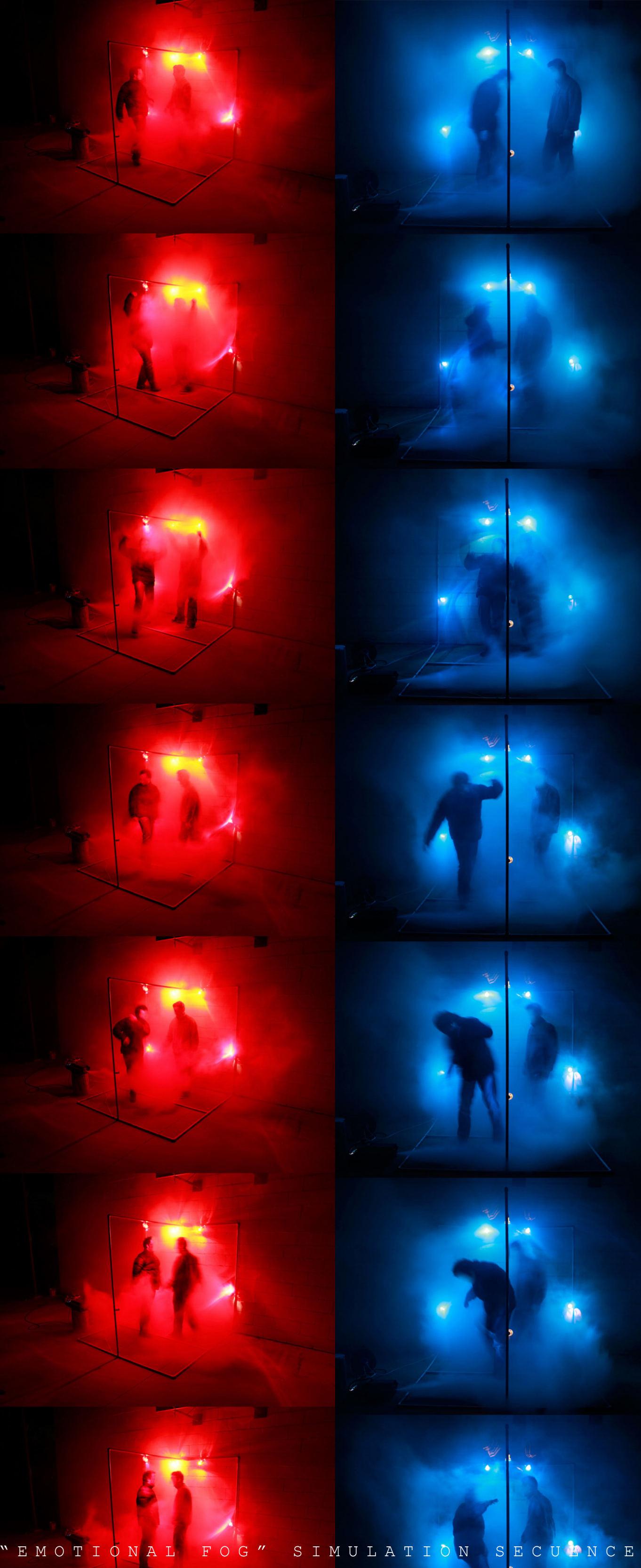

"EMOTIONAL FOG" SIMULATION SEQUENCE