

Motion Actuation: A New Cultural Meme

As you pedal on the new bicycle | pedestrian bridge from Langelinie, you see that Refshaleoen is a thriving urban park with innovations that harness or actuate human movement and elemental motion for the production of clean renewable energy. As you cycle, you feel the bridge gently move with the water's motion and know that a version of the Pelamis P2 Wave Energy generator supports this floating portion of the bridge and converts the water's movement to electricity. The linear lights on the new bicycle superhighway signal the conversion of kinetic energy from the motion of your bicycle wheel into electricity for commuters and the city grid. These smart paths are being installed all over, harvesting the energy of a city on the move and facilitating a new cultural meme towards carbon neutrality.

Through real time tracking on your handlebar mounted smartphone, you see the amount of energy you've generated on this recycled, CE-compliant Pavegen intelligent track surface and are inspired. You feel the sea air and think about human movement and the ecological link with the flow of water, wind and light as it seamlessly moves through time and space just like you. Ahead, a beautiful landscape and installation spreads out before you. To your right is an expansive boardwalk with a sea water pool and bathhouse | café on the quay, also supported by wave energy generators. Ahead is a rich green landscape intersected with the memory of a 'boat slip', and beyond you can see the shimmering silhouette of the Motion Actuation Tower. The journey is an experience in itself.

Once in the park, you change from the fast lane of the bicycle superhighway to the green cycle route and think about the interactive day planned here with friends: meeting at the Motion Actuation Tower's vertical bicycle parking, a walk to the top for a view of the city, a visit to the Little Mermaid below, then to the boardwalk for coffee and a game of Kobenhavn, playing with your children on the motion | energy generating playground (Room for Play), and then the afternoon bike-a-thon. It's a Copenhagen-hygge day full of learning, friends and conversational cycling in an animated and sustainably interconnected park.

Rafshaleoen Site with Green Cycle Route Expansion

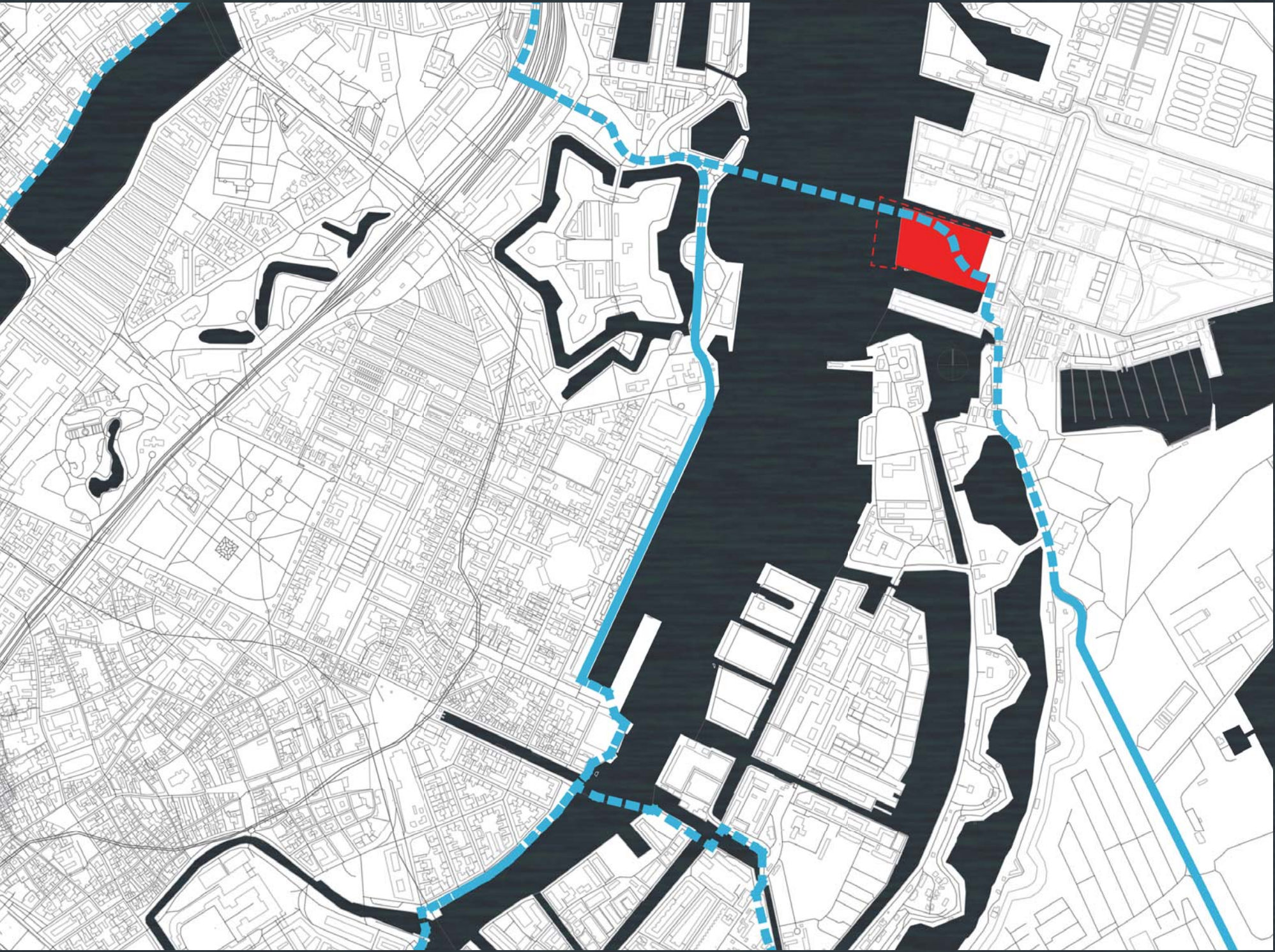

Comparable Tower Heights - Monuments and Industry

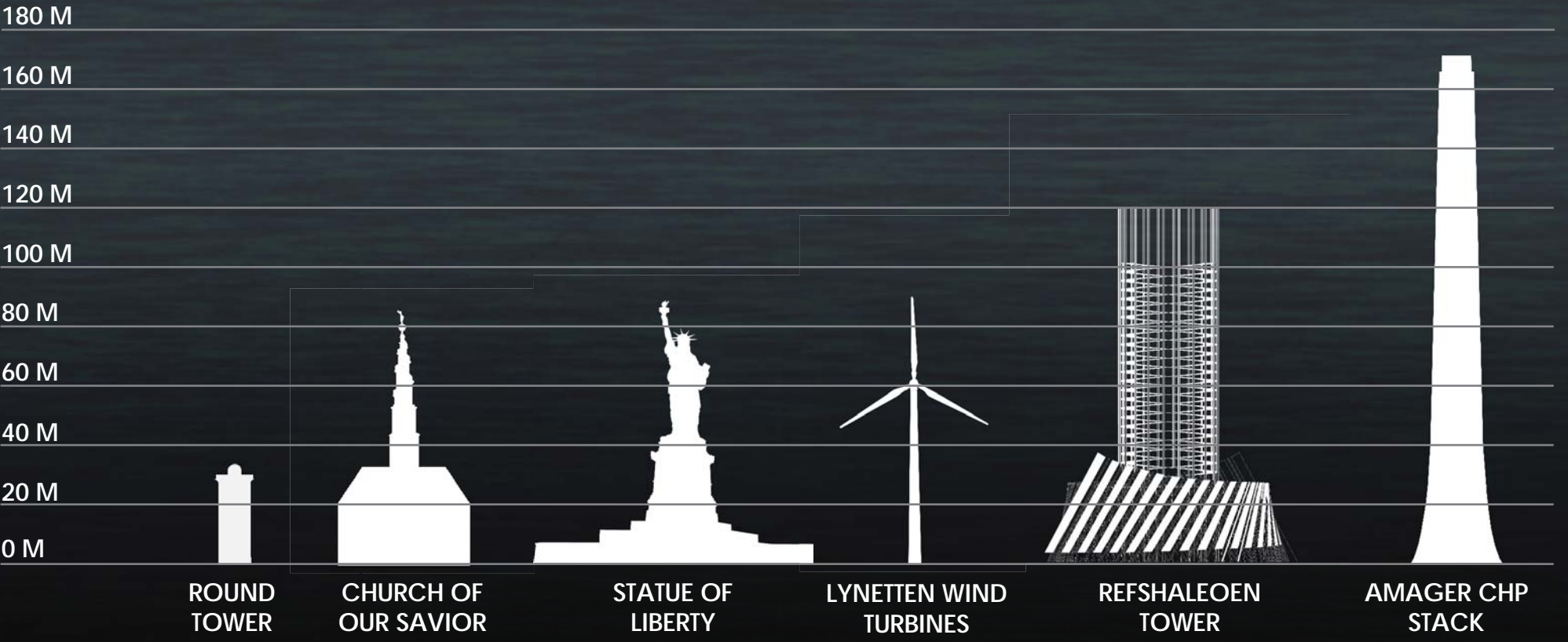

FUTURE BIKE AND PED. BRIDGE TO LANGELINIE



WAVE ENERGY PONTOONS BOARD WALK & BRIDGE



OUTDOOR GAMES PAVEGEN CHESSBOARD



ENERGY GENERATING MOTION PLAYGROUND



CITY VIEW FROM WIND TOWER

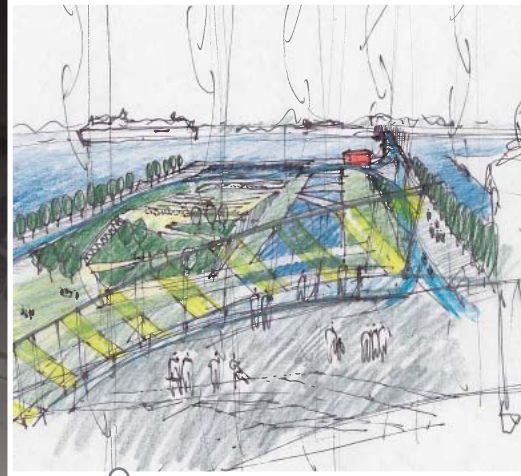

VERTICAL BIKE PARKING ON HELICAL TOWER RAMP



BICYCLE SUPER HIGHWAY CONNECTS THROUGH SITE



COPENHAGEN CULTURAL HERITAGE



VERTICAL AXIS WIND TURBINES AT TOWER



COPENHAGEN CULTURAL HERITAGE



SWIMMING



COFFEE AND CAFE

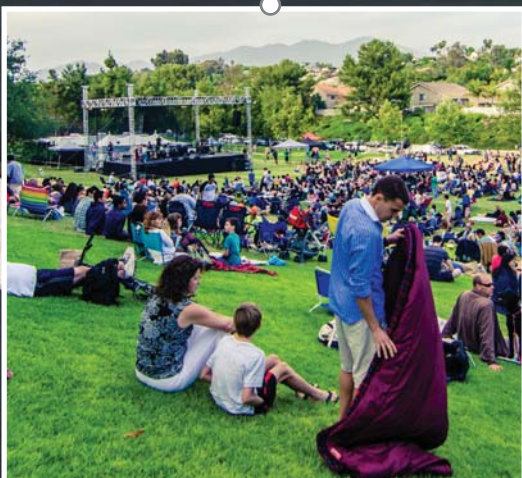

OUTDOOR PERFORMANCE



BOARD WALK



WATER TAXI #991



BOATING



ON THE GREEN



BICYCLE GREEN ROUTE



BICYCLE GREEN ROUTE WITH PAVEGEN TECHNOLOGY



THIN FILM ORGANIC PHOTOVOLTAIC CELLS