



Candle Mill



Refshaleøen has been re-imagined as an elevated platform, which creates a far-reaching display of the process of harvesting natural energy from the wind. The sculptures bold silhouette on harbours low topography reaches up to the sky with its curved tapered plinth, deck and sail-like structure of wind generators. This ship-like resemblance however, is not superficial and has derived from the necessity of its purpose; this is in the end a machine.

The pragmatic side of the art-generator task has been capturing and storing the green energy in absolute coordination with demand. The main problem in harvesting energy from the wind is the fact that it is intermittent which means it is not reliable. Our idea is to capture wind energy and use it to pump water up to provide a reliable energy source on demand. The proposed side specifics naturally lead us to the pumped hydro solution. The managing and control of the sea is what Denmark has done for centuries and we are using the sea to generate and store energy.

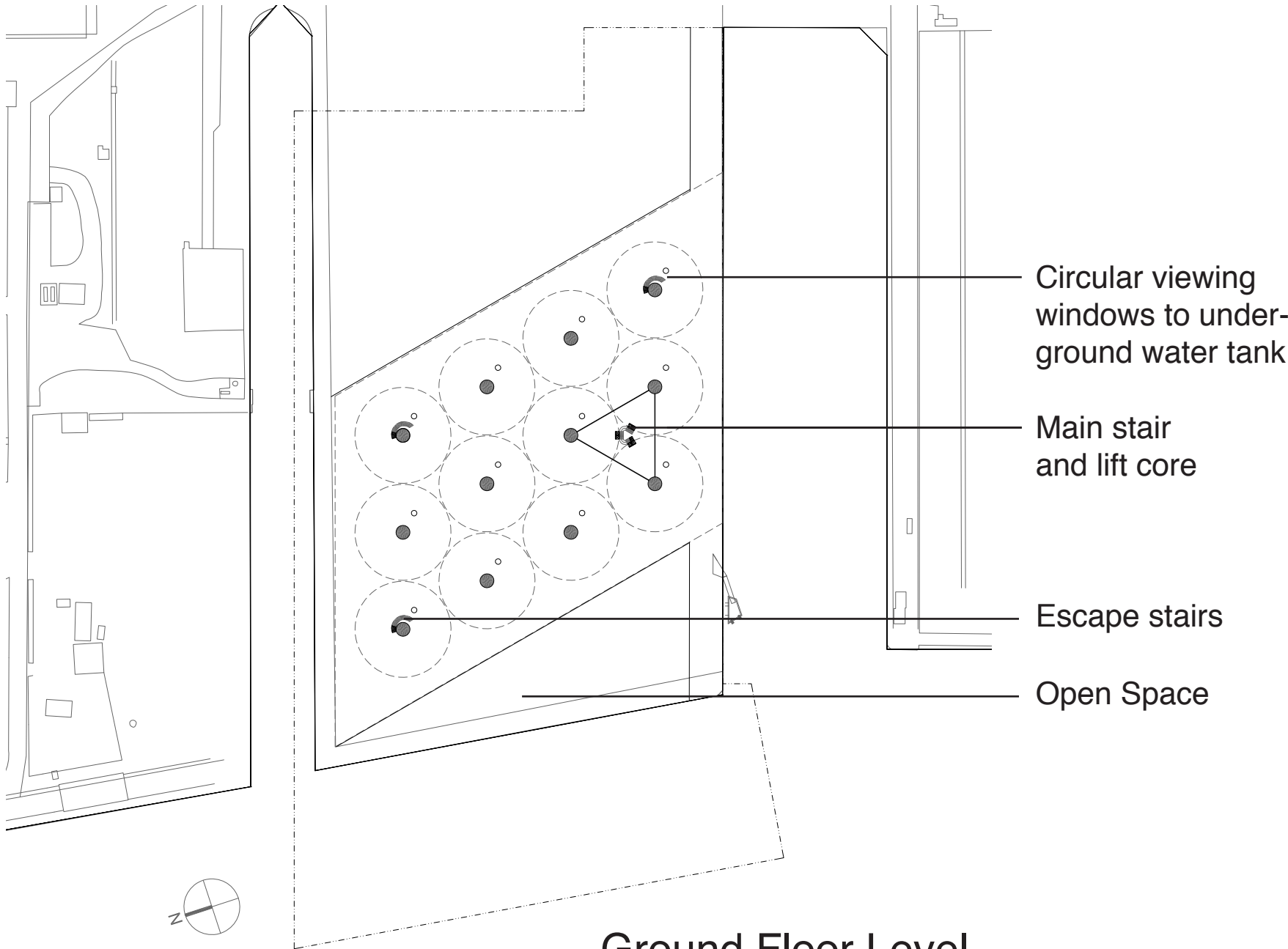

Ground Floor Level

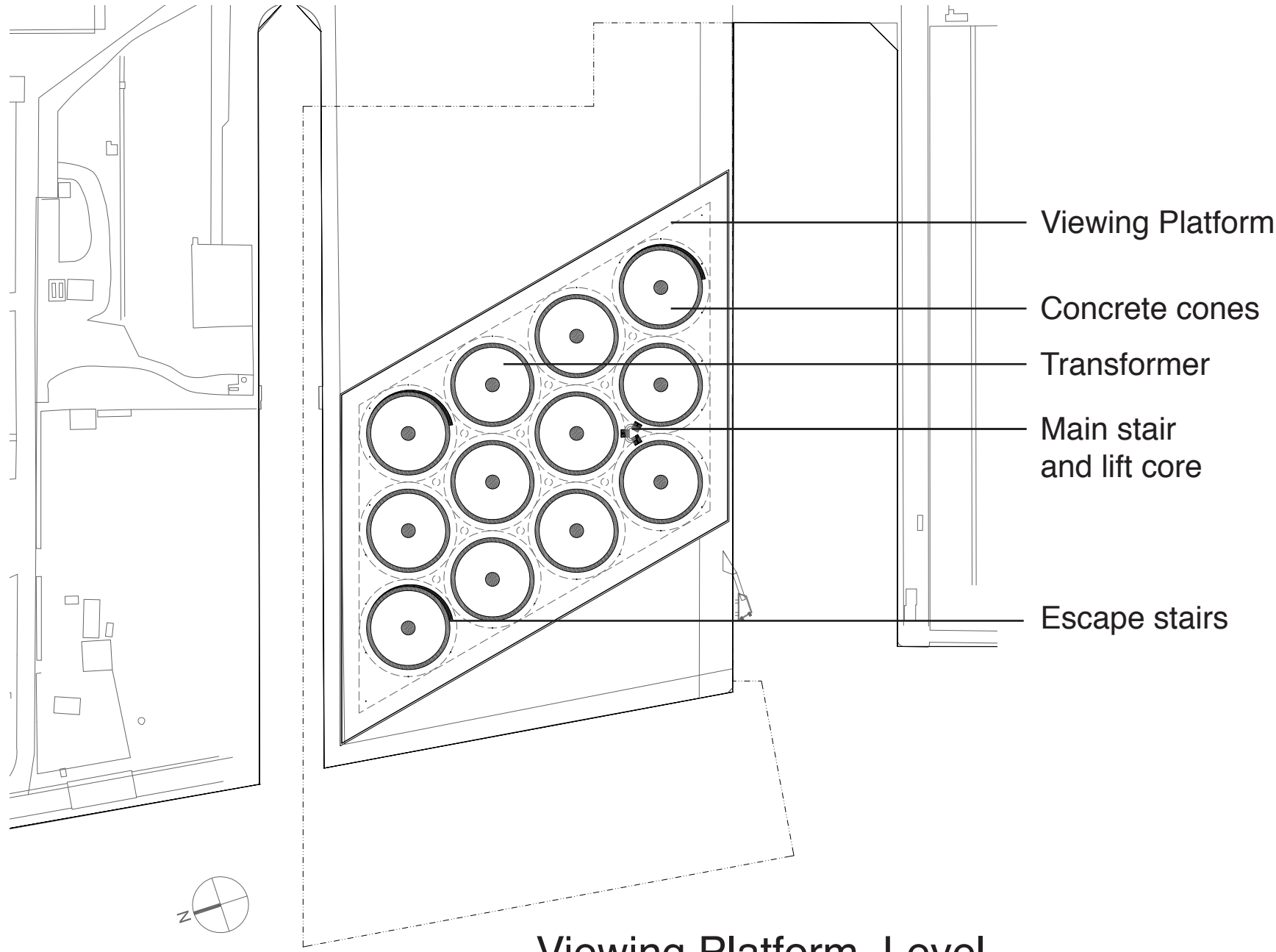

Viewing Platform Level +50m