

Structural System

Modulation System

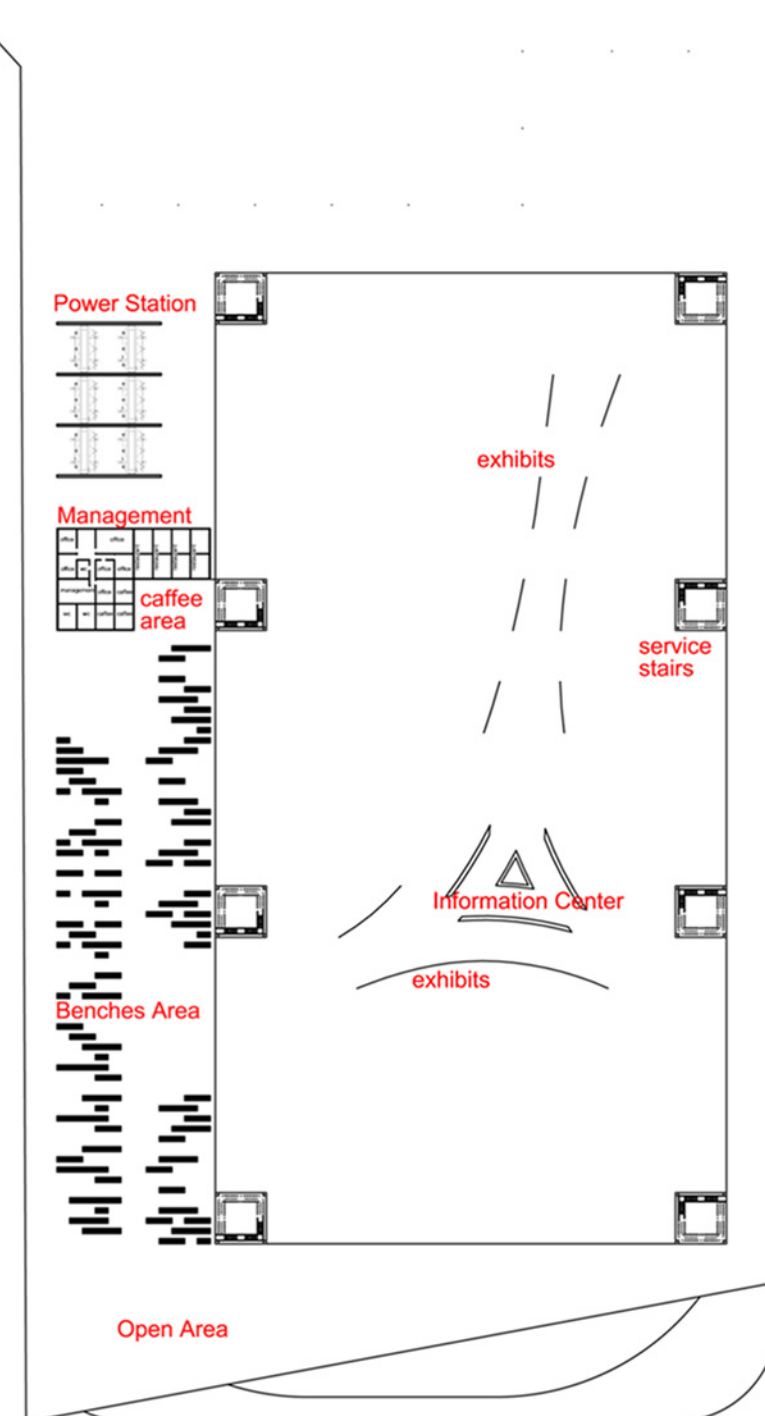

Technical and Services

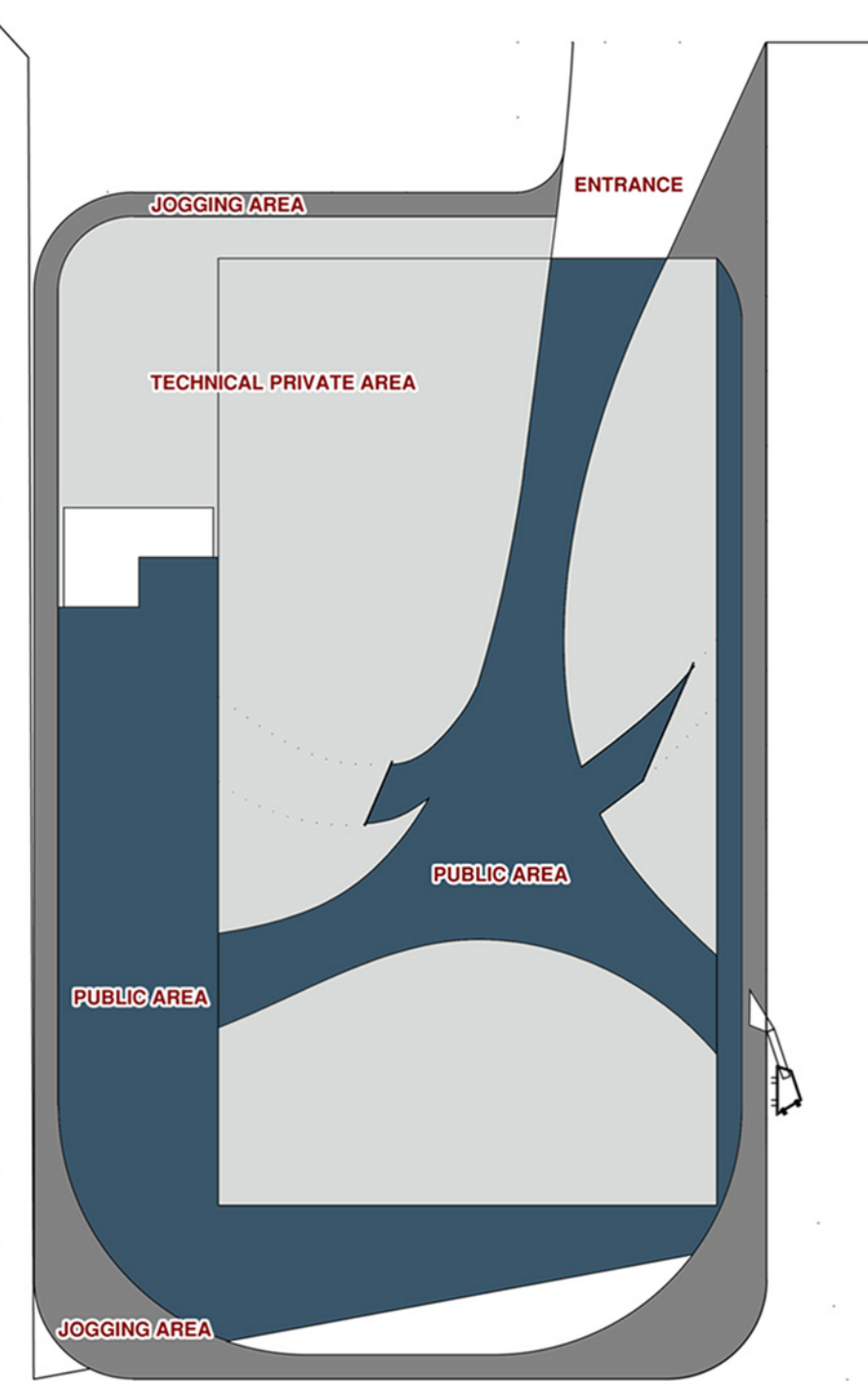

Circulation System

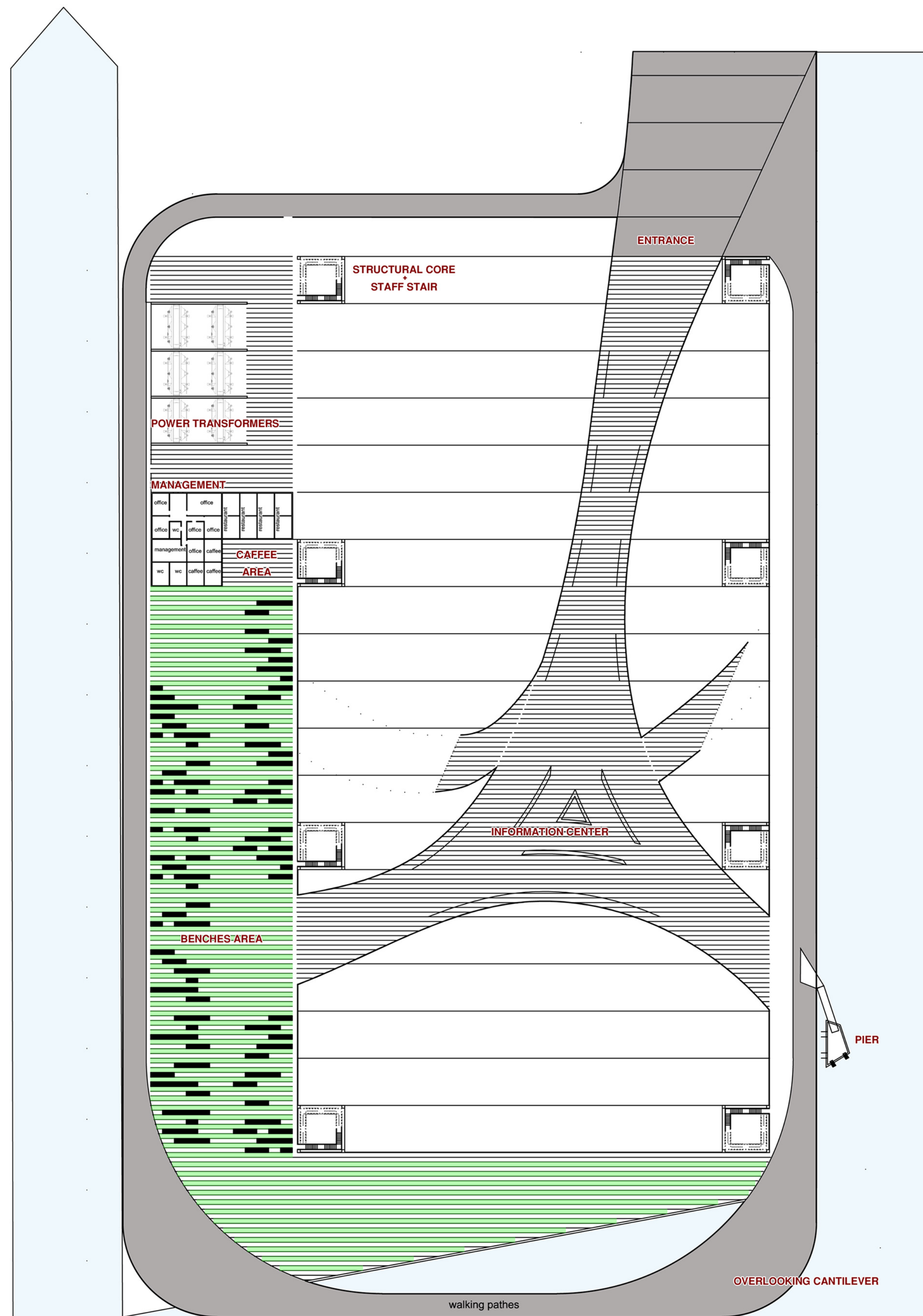

SITE PLAN

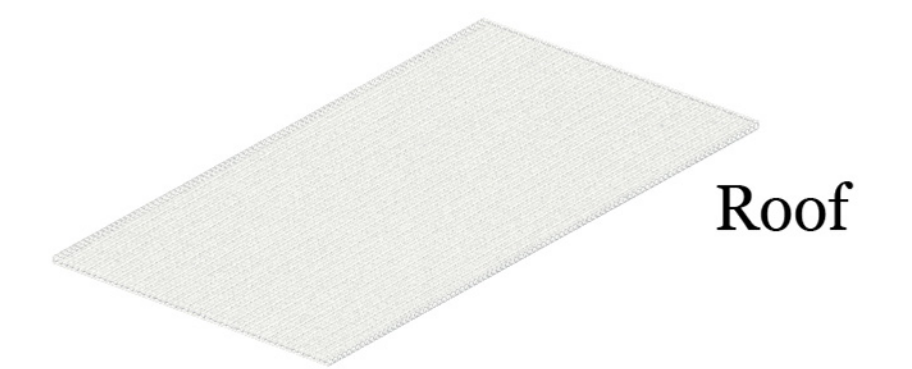

Roof

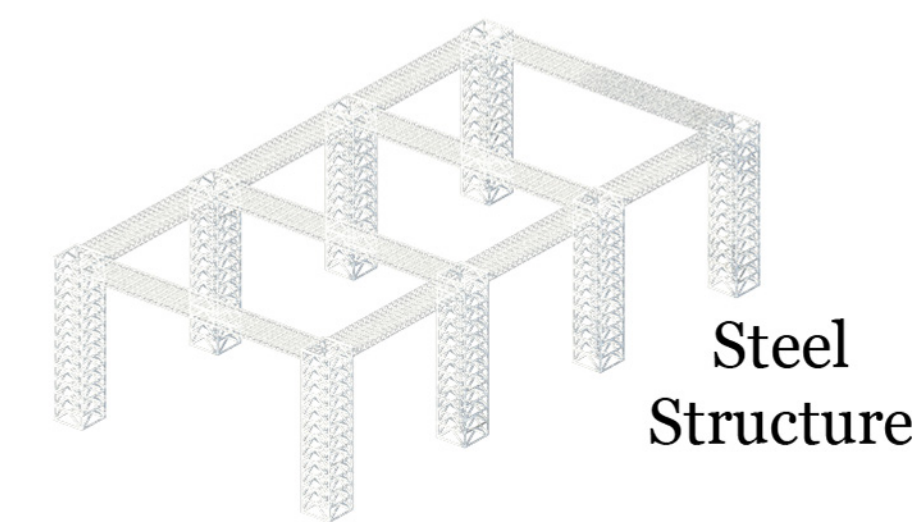

Steel Structure

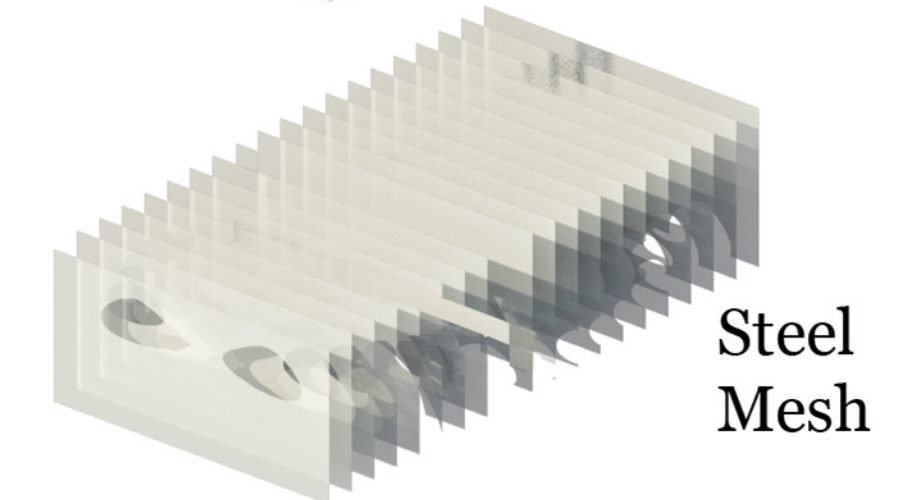

Steel Mesh

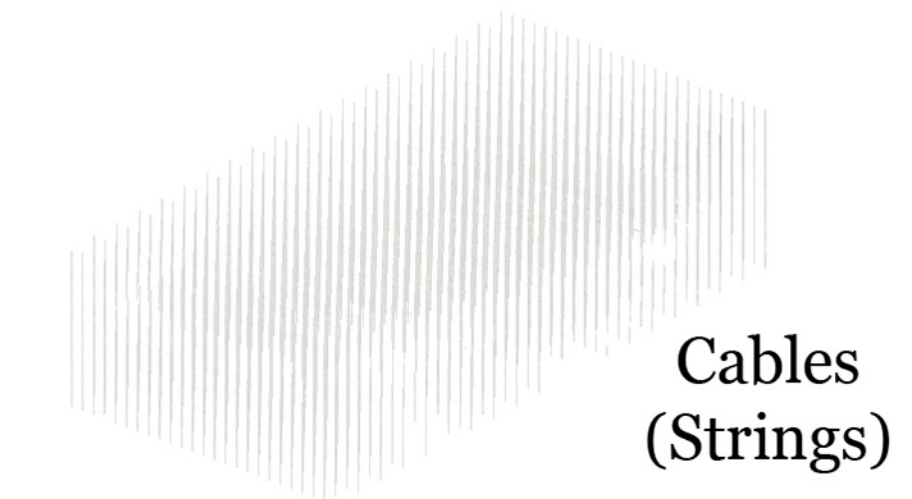

Cables (Strings)

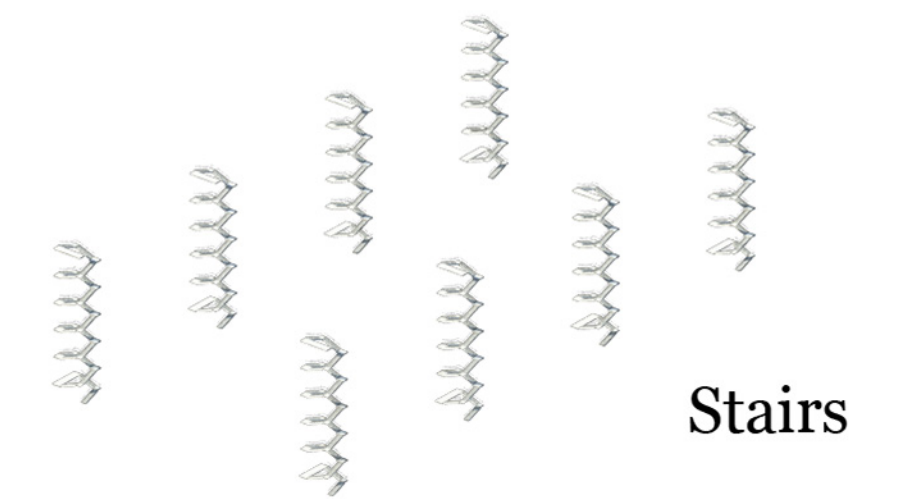

Stairs

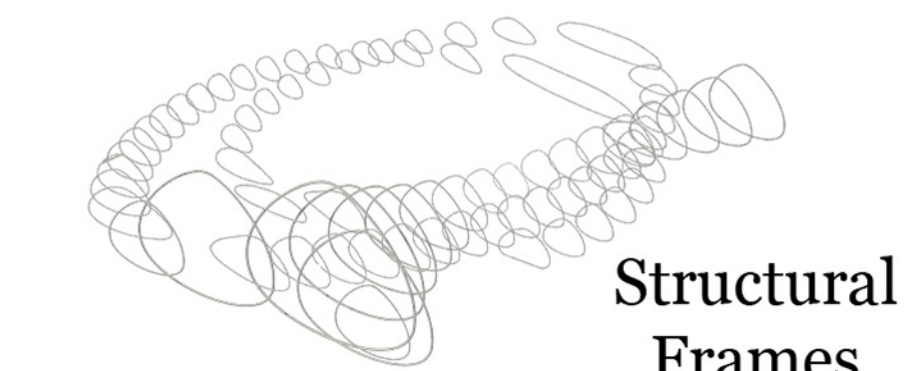

Structural Frames

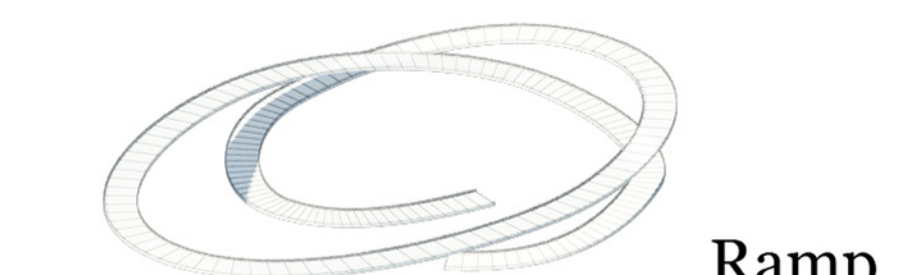

Ramp

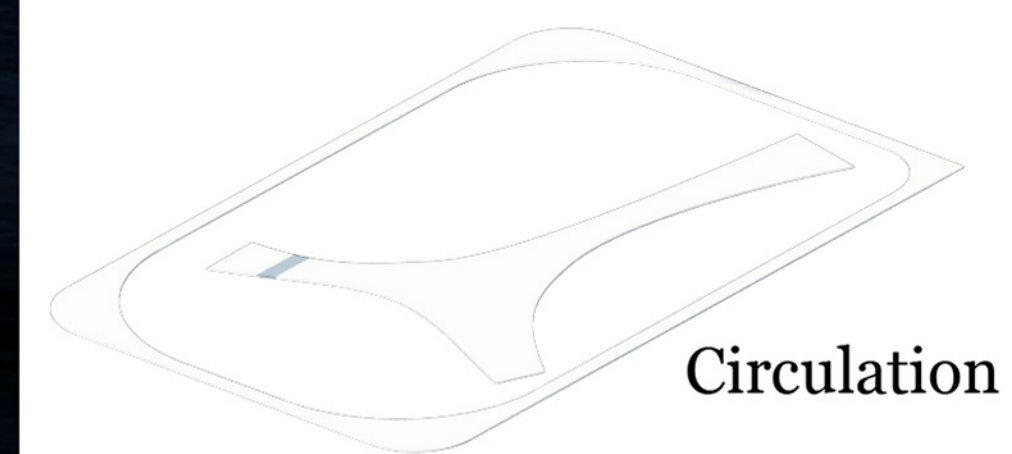

Circulation

Systems

On the road of zero consumption with the renewable energy to become the first zero-emission capital by 2025, Copenhagen needs to engage the people in this vision and spread the culture of renewable energy and make it part of people's daily life and entertainment and social trend. "String of Future" project is bringing positive social and cultural attention by its aesthetic phenomenon and its added value to the city's public social life. People are coming and doing social activities together to support sustainable development.

Efficiency

The wind electric power generator has relatively low investment and operating costs, and operates without pollution or detrimental environmental effects.

Using steel structure instead of concrete masses in such volume construction helps in CO2 emissions reduction results.

An engagement breakthrough

In spite of having the ability to power 10,000 of households with clean and renewable energy, this monumentality and uniqueness of design in its scale and language, makes it a symbol in Copenhagen. It refers to its meanings and functions and makes from the project more than power generation project. It makes from the project a culture of engagement breakthrough.