

EXCAVATING THE HIDDEN POWER

The nominally buried residual steam is redistributed throughout the excavated site. Heat from underground converts water into steam, some of which released in steam nozzles, others condensing back on the inside face of the balloon surface. A thermal reservoir is created to provide a thermal landscape that stretches public activities across longer seasons.

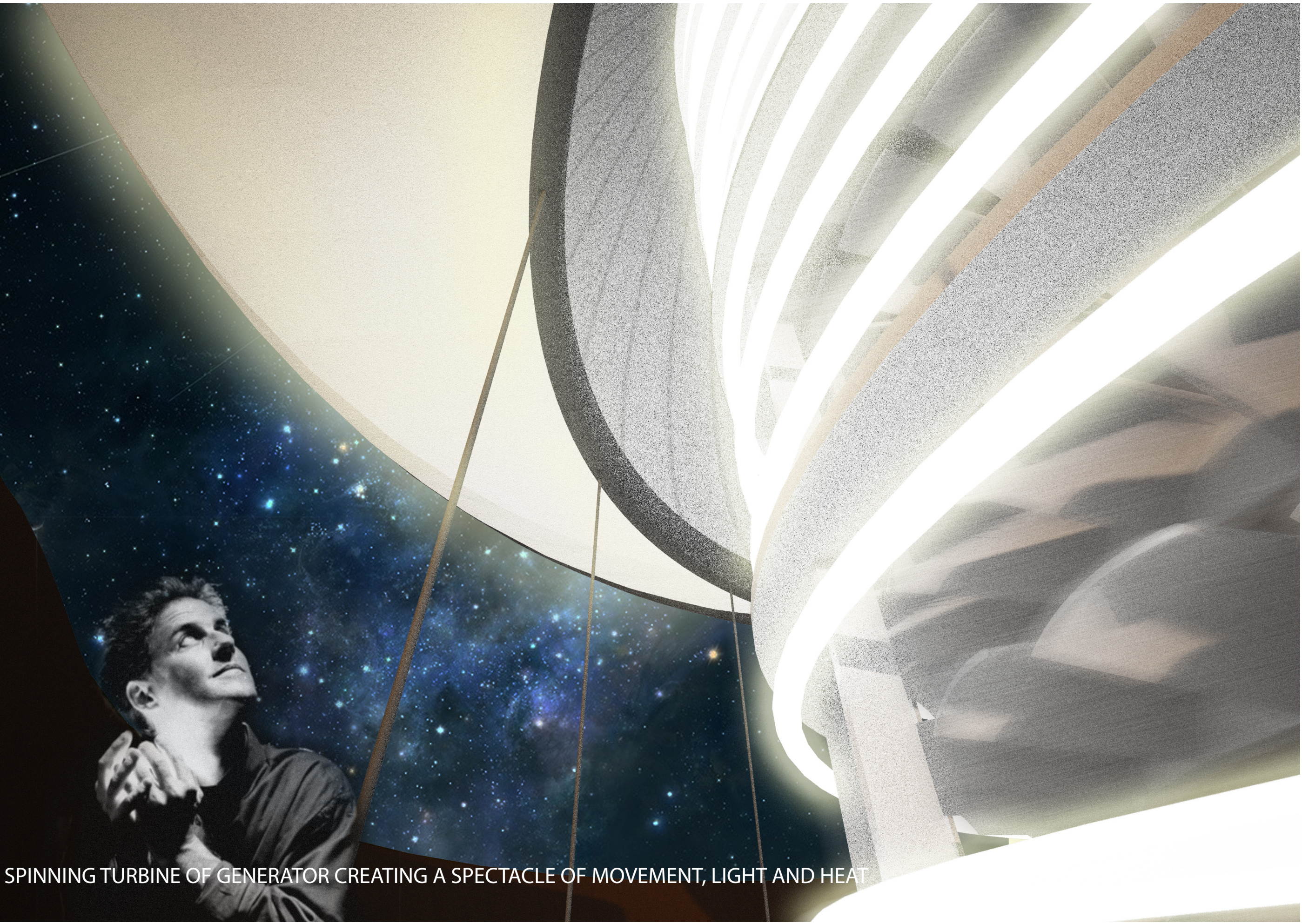
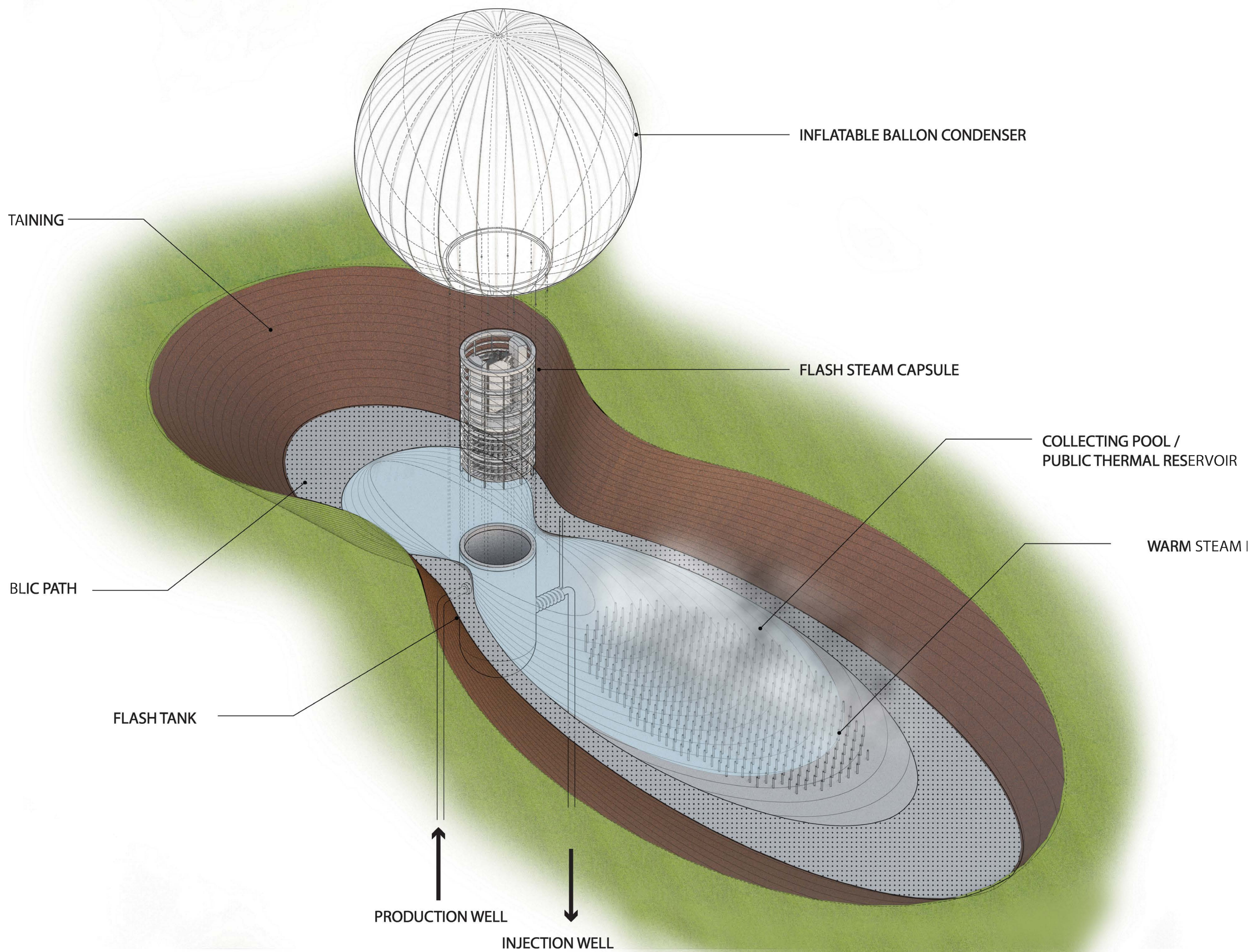
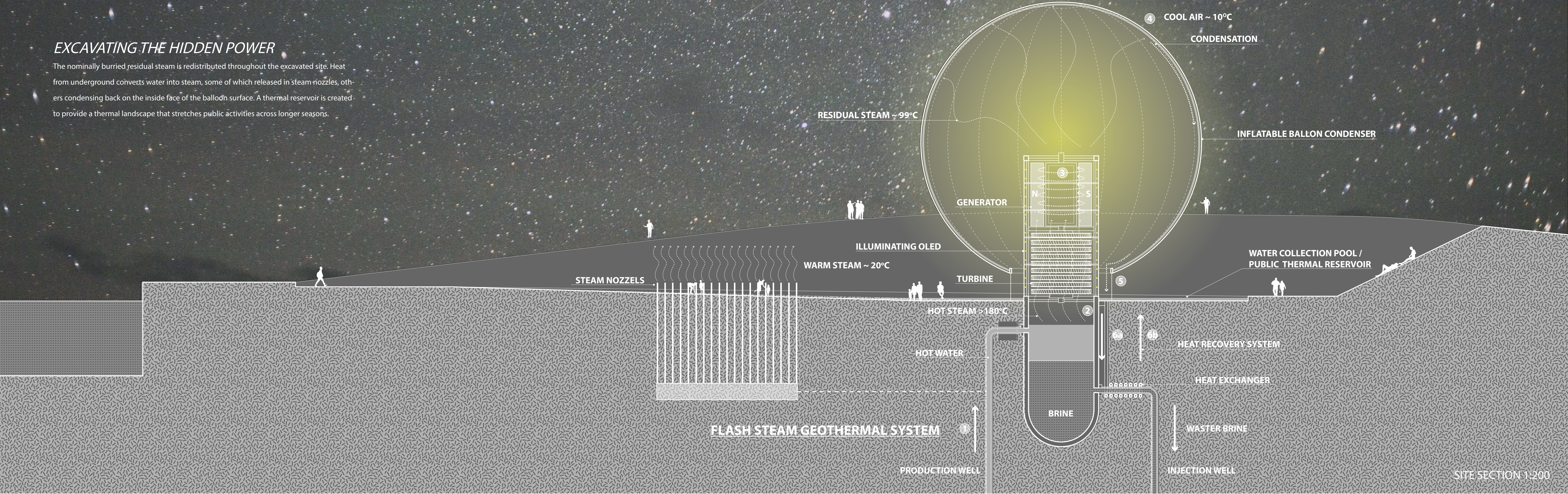

SPINNING TURBINE OF GENERATOR CREATING A SPECTACLE OF MOVEMENT, LIGHT AND HEAT